



SAFETY: Lower Sash Handle is designed to be aerodynamic, eliminating turbulence as air enters the hood.

DESIGN: Sash Height is 35", providing a clear, unobstructed view of the hood interior.

DESIGN: Full View Combination Sash features top hung rollers and full contact guides at the lower edge of the panels, this allows for smoother sash operation.

SAFETY: Keyed Sash Locks stops the sash from rising above the 18" operating position. Unlocked sash provides a 27 1/2" setup position.



PERFORMANCE: Flush Airfoil with secondary containment trough and safety bar allow for optimal performance and safety.

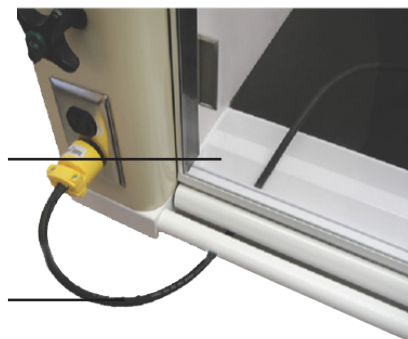

SAFETY: Card Slot allows cords to pass through and the sash to be fully closed.

The CiF APEX-air HP Series fume hood

is a fume hood designed to provide maximum personal protection at an economical operating cost? Operating at an exhaust volume of less than half of a conventional hood, the CiF HP Series hood not only saves money by reducing the volume of air that needs to be conditioned and exhausted, but it also reduces the size of the HVAC equipment, saving on the original capital investment. Although efficiency is the goal of design, we have not compromised that you purchase a fume hood in the first place. Safety!

Standard Features

- Rounded corners at the hood entrance and aerodynamic sash pull both allow for smooth airflow with less turbulence.
- Rounded corners at the hood entrance and aerodynamic sash pull both allow for smooth airflow with less turbulence.
- Flush sill containment trough with an angled surface and a white Plas-Cote finish for durability and chemical resistance.
- 35" high viewing area with a maximum sash opening of 27.5" high.
- UL Listed, white fiberglass reinforced thermoset polyester interior lining and a round 304 stainless steel duct collar.
- The sash operates with a chain and sprocket mechanism.



53 Courtland Avenue | Vaughan, Ontario, Canada L4K 3T2
905.738.5821 | www.cifsolutions.com

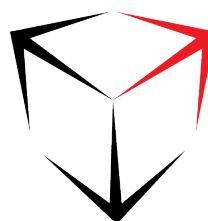

*ASHRAE 110 and NIH modified protocol Independent Third-Party Tested

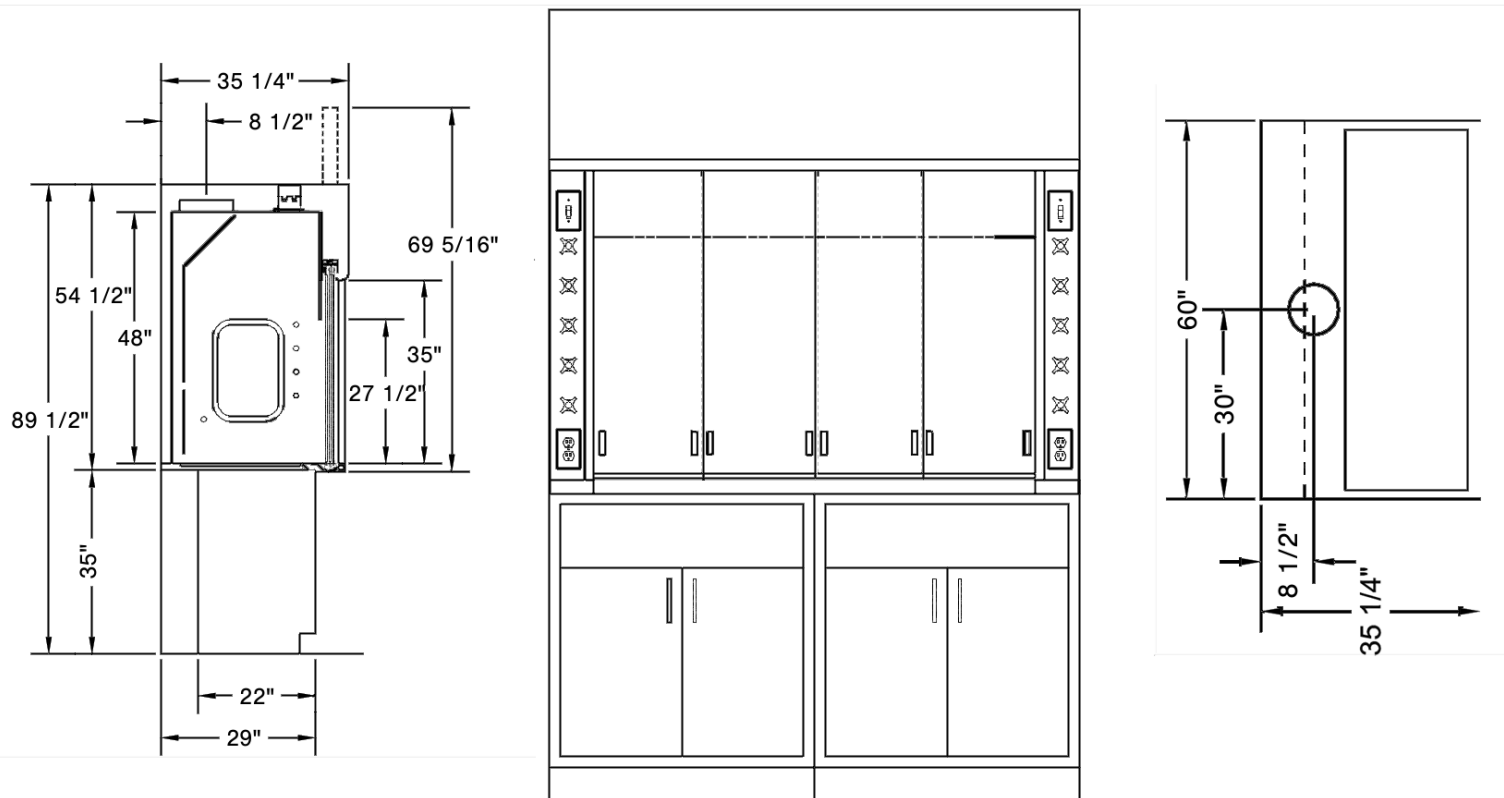

APEX-air HP Fume Hood Airflow Data

Hood Size (feet)	Collar Size Diameter (inches)	EXHAUST DATA @ 100 FPM				
				Face Velocity		
		CFM	SP	18" Vertical	27.5" Vertical	Horizontal
4	8	380	.13	80	52*	107
5	8	500	.19	80	52*	106
6	10	620	.14	80	52*	106
8	2 (8)	860	.15	80	52*	106

*27.5" vertical opening should be used for set-up only

CFM (cubic feet per minute) SP (static pressure)



53 Courtland Avenue | Vaughan, Ontario, Canada L4K 3T2
905.738.5821 | www.cifsolutions.com

©2024 CiF Lab Solutions LP

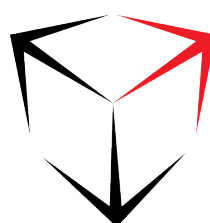

CiFLABSOLUTIONS