

# Contents

General Information.....	AC-2
Art & Ceramics .....	AC-3
Base Storage.....	AC-4
Tall Storage.....	AC-5
Tote Tray Storage Tall Cabinets.....	AC-7
Spray Booth.....	AC-10
Arts & Crafts Index .....	AC-12

# General Information

**Please review the following for Arts and Crafts product information. Contact your CiF Solutions dealer for any clarifications.**

Casework shown in this section has been pre-engineered specifically for use in the Arts and Crafts department.

Be sure to utilize fillers, especially at walls and corners, for proper leveling and to allow for door and drawer opening clearances.

Cabinets that require locks, finished ends, finished backs, finished tops, specialty hardware or devices, and other options, must be clearly called out or specified accordingly.

# Art & Ceramics

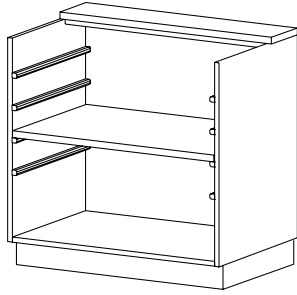
**CAT. NO** **X5000**
**DESCRIPTION** **Enlarger Station**  
 • Adjustable height work surface

**HEIGHT** 30 | 32 | 34 | 36

**DEPTH** 24

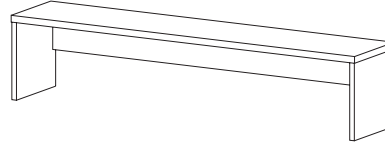
**WIDTH** 30 | 33 | 36

**H8000**
**Bench Riser**  
 • Provides additional countertop storage

**HEIGHT** 12

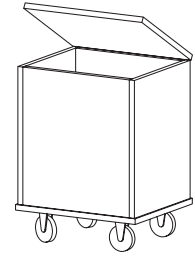
**DEPTH** 12

**WIDTH** 52 | 59

**X1730**
**Clay Cart**  
 • Galvanized metal liner w/drain  
 • Hinged lid

**HEIGHT** 24

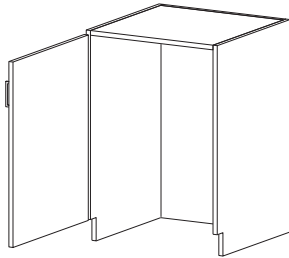
**DEPTH** 16 | 20 | 24

**WIDTH** 18

**CAT. NO** **X1710**      **X1720**
**DESCRIPTION** **Clay Cart Port**  
 • One hinged door  
 • Can be used to store X1700 or X1730

**HEIGHT** 29 | 32.75 (ADA) | 35

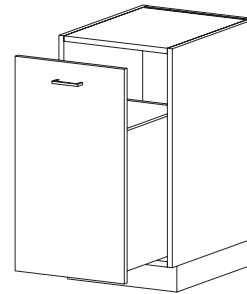
**DEPTH** 23

**WIDTH** 24

**X1760**
**Pull-Out Clay Bin**  
 • Galvanized metal liner  
 • Convenient pull-out design

**HEIGHT** 35

**DEPTH** 23

**WIDTH** 24

# Base Storage

Refer to the Base Casework section for a complete line of storage solutions.

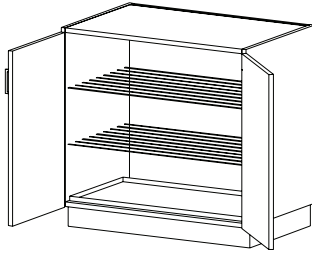

**CAT. NO** B0260

**DESCRIPTION** Damp Storage w/Doors  
 • Two vinyl-coated wire shelves  
 • One metal drip tray

**HEIGHT** 29 | 32.75 (ADA) | 35 | 39 | 42 | 48

**DEPTH** 23 | 29 | 35

**WIDTH** 24 | 27 | 30 | 33 | 36 | 39 | 42 | 45 | 48

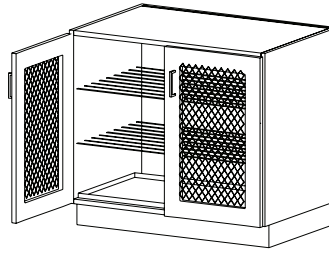

**B0280**

**Drying Cabinet**  
 • Two vinyl-coated wire shelves  
 • One metal drip tray  
 • Expanded metal doors

29 | 32.75 (ADA) | 35 | 39 | 42 | 48

23 | 29 | 35

24 | 27 | 30 | 33 | 36 | 39 | 42 | 45 | 48

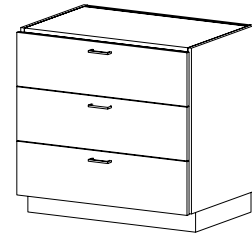

**B4130**

**Three Drawer Paper Storage**  
 • Drawers feature paper retaining hoods and full extension drawer slides

23 | 26 | 29 | 32.75 (ADA) | 35

23 | 29 | 35

24 | 27 | 30 | 33 | 36 | 39 | 42 | 48

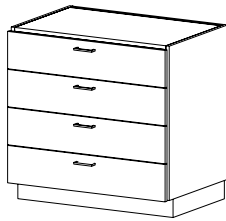

**CAT. NO** B4140

**DESCRIPTION** Four Drawer Paper Storage  
 • Drawers feature paper retaining hoods and full extension drawer slides

**HEIGHT** 23 | 26 | 29 | 32.75 (ADA) | 35

**DEPTH** 23 | 29 | 35

**WIDTH** 24 | 27 | 30 | 33 | 36 | 39 | 42 | 48

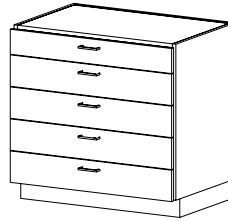

**B4150**

**Five Drawer Paper Storage**  
 • Drawers feature paper retaining hoods and full extension drawer slides

29 | 32.75 | 35

23 | 29 | 35

24 | 27 | 30 | 33 | 36 | 39 | 42 | 48

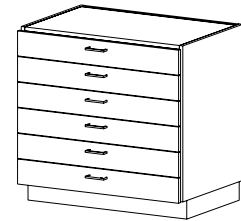

**B4160**

**Six Drawer Paper Storage**  
 • Drawers feature paper retaining hoods and full extension drawer slides

32.75 | 35

23 | 29 | 35

24 | 27 | 30 | 33 | 36 | 39 | 42 | 48

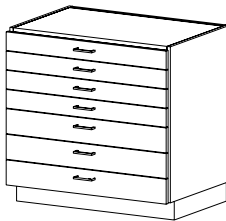

**CAT. NO** B4170

**DESCRIPTION** Seven Drawer Paper Storage  
 • Drawers feature paper retaining hoods and full extension drawer slides

**HEIGHT** 32.75 | 35

**DEPTH** 23 | 29 | 35

**WIDTH** 24 | 27 | 30 | 33 | 36 | 39 | 42 | 48

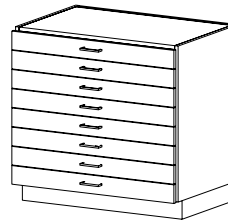

**B4180**

**Eight Drawer Paper Storage**  
 • Drawers feature paper retaining hoods and full extension drawer slides

35

23 | 29 | 35

24 | 27 | 30 | 33 | 36 | 39 | 42 | 48

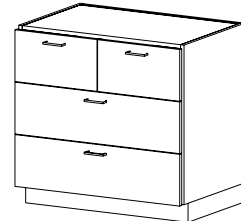

**B4230**

**Four Drawer Storage**  
 • Four drawers

23 | 26 | 29 | 32.75 | 35

16 | 23

24 | 27 | 30 | 33 | 36 | 39 | 42 | 48

# Tall Storage

Refer to the Tall Casework section for a complete line of storage solutions.

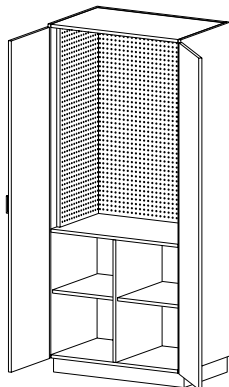

**CAT. NO** T4140

**DESCRIPTION**

**Tool Storage**

- Upper compartment lined w/pegboard
- Two adjustable shelves in lower compartment
- Two hinged doors

**HEIGHT** 72 | 78 | 84

**DEPTH** 24

**WIDTH** 30 | 33 | 36 | 39 | 42 | 45 | 48

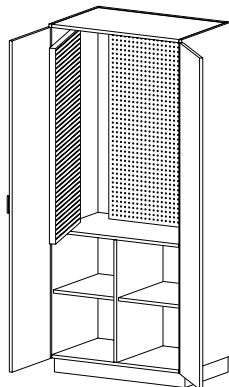

**T4160**

**Tool Storage**

- Upper compartment has two pivoting pegboard panels
- Two adjustable shelves in lower compartment
- Two hinged doors

72 | 78 | 84

24

30 | 33 | 36 | 39 | 42 | 45 | 48

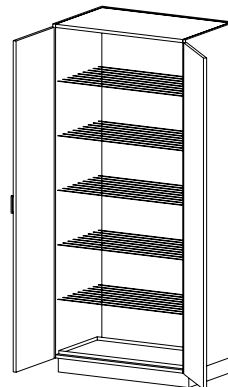

**T0540**

**Damp Storage**

- Adjustable vinyl-coated wire shelves
- One metal drip tray
- Two hinged doors w/seal

72 | 78 | 84 | 86 | 88 | 90 | 95

24

27 | 30 | 33 | 36 | 39 | 42  
45 | 48

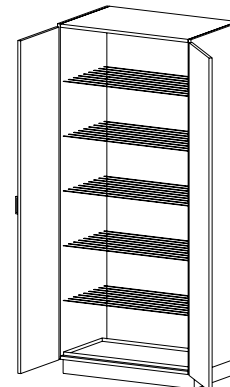

**T0550**

**Damp Storage**

- Adjustable vinyl-coated wire shelves
- One metal drip tray
- Interior lined w/galvanized metal
- Two hinged doors w/seal
- Widths 39-48 require an additional bracket per shelf and an additional standard per cabinet.

72 | 78 | 84 | 86 | 88 | 90 | 95

24

27 | 30 | 33 | 36 | 39 | 42  
45 | 48

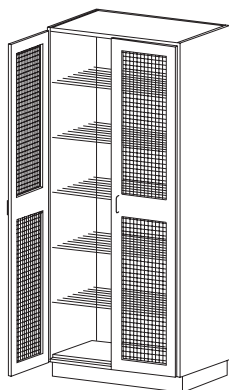

**CAT. NO** T0560

**DESCRIPTION**

**Drying Cabinet**

- Adjustable vinyl-coated wire shelves
- One metal drip tray
- Two ventilated hinged doors w/expanded metal inserts

**HEIGHT** 72 | 78 | 84 | 86 | 88 | 90 | 95

**DEPTH** 24

**WIDTH** 27 | 30 | 33 | 36 | 39 | 42  
45 | 48

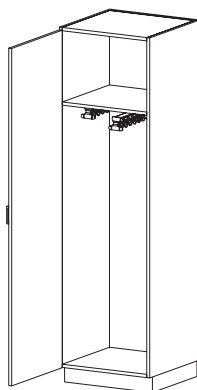

**T2510** (Hinged L) **T2520** (Hinged R)

**Smock Storage**

- One fixed shelf
- One hinged door
- Two pull-out racks mounted under shelf – each rack features 14 hooks

84

24

24

# Tall Storage (cont'd)

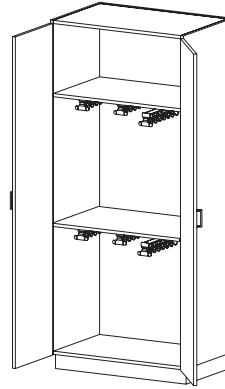
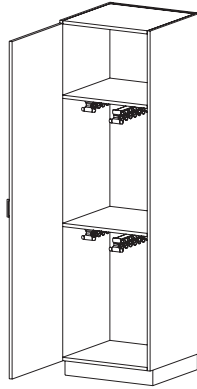
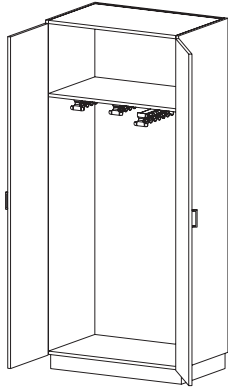
**CAT. NO** **T2500**
**DESCRIPTION**
**Smock Storage**

- One fixed shelf
- Two hinged doors
- Three pull-out racks mounted under shelf (48" width has four racks) – each rack features 14 hooks

**HEIGHT** 84

**DEPTH** 24

**WIDTH** 36 | 39 | 42 | 45 | 48

**T2610** **T2620**  
 (Hinged L) (Hinged R)

**Apron Storage**

- Two fixed shelves
- One hinged door
- Two pull-out racks mounted under each shelf – each rack features 14 hooks

**HEIGHT** 84

**DEPTH** 24

**WIDTH** 24

**T2600**
**Apron Storage**

- Two fixed shelves
- Two hinged doors
- Three pull-out racks mounted under each shelf (48" width has four racks per shelf) – each rack features 14 hooks

**HEIGHT** 84

**DEPTH** 24

**WIDTH** 36 | 39 | 42 | 45 | 48

# Tote Tray Storage Tall Cabinets

All tote tray cabinets include high impact resistant polystyrene trays. Tote trays are supported by ribbed polystyrene panels mounted to the cabinet ends and partitions. All trays include an aluminum label holder.

Tote tray quantity varies by cabinet height. Consult the table at right for exact counts.

## Tote Tray Sizes

- TT100** 12½" w x 19" d x 4⅝" h
- TT110** 12½" w x 19" d x 3½" h
- TT120** 10" w x 19" d x 4" h
- TT130** 10" w x 19" d x 3½" h
- TT140** 14" w x 18" d x 3½" h
- TT150** 14" w x 18" d x 4" h

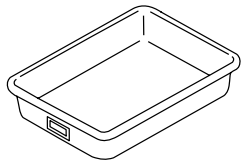

## Tote Tray Quantity Per Cabinet

		Cabinet Height		
		72	78	84
<b>Cabinet Model No.</b>	<b>T1400</b>	36	42	42
	<b>T1410</b>	24	28	28
	<b>T1420</b>	24	28	28
	<b>T1430</b>	24	28	28
	<b>T1440</b>	36	42	42
	<b>T1450</b>	48	54	60
	<b>T1460</b>	48	54	60
	<b>T1470</b>	15	15	15
	<b>T1480</b>	21	21	21
	<b>T1500</b>	48	56	56
	<b>T1510</b>	32	36	40
	<b>T1520</b>	32	36	40
	<b>T1530</b>	32	36	40
	<b>T1540</b>	48	56	56
	<b>T1550</b>	64	72	80
<b>T1560</b>	64	72	80	
<b>T1570</b>	20	20	20	
<b>T1580</b>	28	28	28	

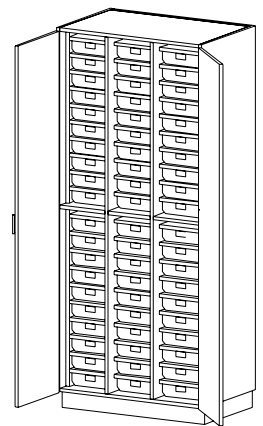
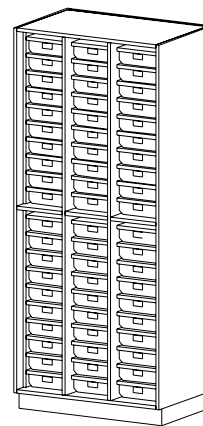
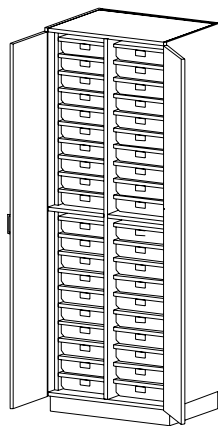
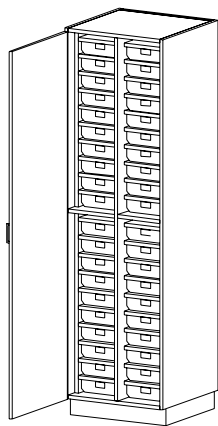
**CAT. NO**
**T1510**  
(Hinged L)

**T1520**  
(Hinged R)

**DESCRIPTION**

- Tote Tray Storage with Door**
- One fixed vertical partition
  - Two fixed shelves
  - Tote tray size: TT130
  - One hinged door

**T1530**

- Tote Tray Storage with Doors**
- One fixed vertical partition
  - Two fixed shelves
  - Tote tray size: TT110
  - Two hinged doors

**T1450**

- Open Tote Tray Storage**
- Two fixed vertical partitions
  - Three fixed shelves
  - Tote tray size: 36" w – TT130, 48" w – TT140

**T1460**

- Tote Tray Storage with Doors**
- Two fixed vertical partitions
  - Three fixed shelves
  - Tote tray size: 36" w – TT130, 48" w – TT140
  - Two hinged doors

**HEIGHT** 72 | 78 | 84

72 | 78 | 84

72 | 78 | 84

72 | 78 | 84

**DEPTH** 23

23

23

23

**WIDTH** 24

30

36 | 48

36 | 48

# Tote Tray Storage Tall Cabinets (cont'd)

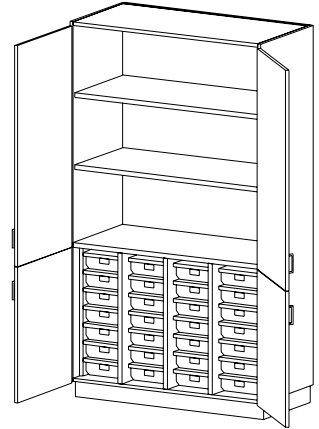
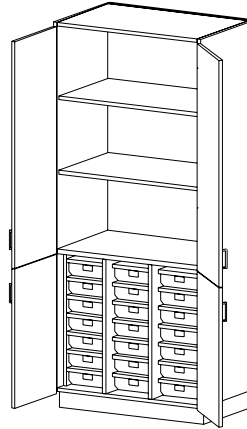
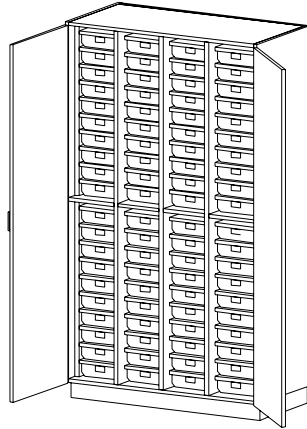
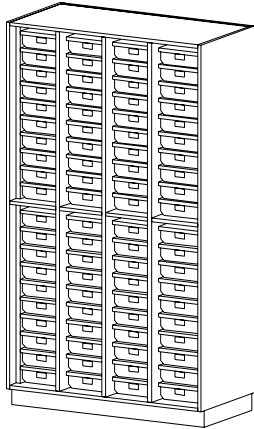
**CAT. NO** **T1550**
**DESCRIPTION**
**Open Tote Tray Storage**

- Three fixed vertical partitions
- Tote tray size: TT130

**HEIGHT** 72 | 78 | 84

**DEPTH** 23

**WIDTH** 48

**T1560**
**Tote Tray Storage with Doors**

- Three fixed vertical partitions
- Tote tray size: TT130
- Two hinged doors

72 | 78 | 84

23

48

**T1480**
**Tote Tray Storage with Doors**

- Two adjustable shelves
- Two fixed vertical partitions
- Tote tray size: 36" w – TT130, 48" w – TT140
- Doors split at fixed shelf

72 | 78 | 84

23

36 | 48

**T1580**
**Tote Tray Storage with Doors**

- Two adjustable shelves
- Three fixed vertical partitions
- Tote tray size: TT130
- Four hinged doors
- Doors split at fixed shelf

72 | 78 | 84

23

48

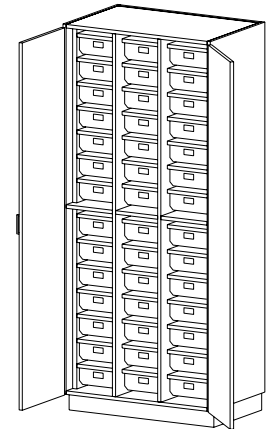
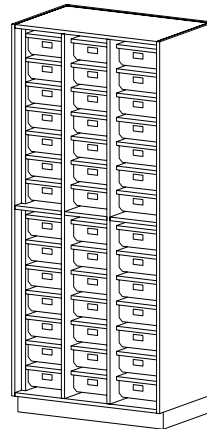
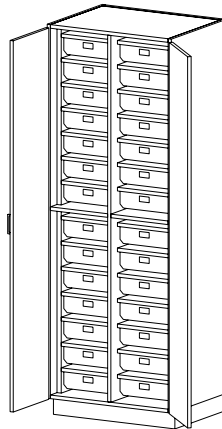
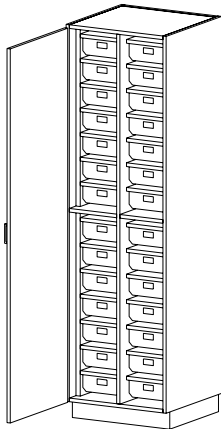
**CAT. NO** **T1410** (Hinged L) **T1420** (Hinged R)

**DESCRIPTION**
**Tote Tray Storage with Door**

- One fixed vertical partition
- Tote tray size: TT120
- One hinged door

**HEIGHT** 72 | 78 | 84

**DEPTH** 23

**WIDTH** 24

**T1430**
**Tote Tray Storage with Doors**

- One fixed vertical partition
- Tote tray size: TT100
- Two hinged doors

72 | 78 | 84

23

30

**T1400**
**Open Tote Tray Storage**

- Two fixed vertical partitions
- Tote tray size: 36" w – TT120, 48" w – TT150

72 | 78 | 84

23

36 | 48

**T1440**
**Tote Tray Storage with Doors**

- Two fixed vertical partitions
- Tote tray size: 36" w – TT120, 48" w – TT150
- Two hinged doors

72 | 78 | 84

23

36 | 48

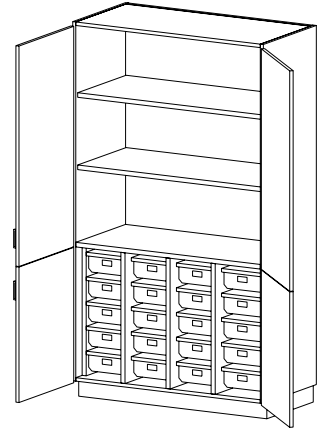
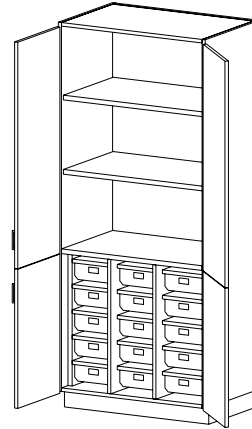
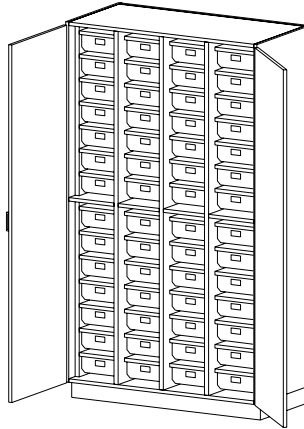
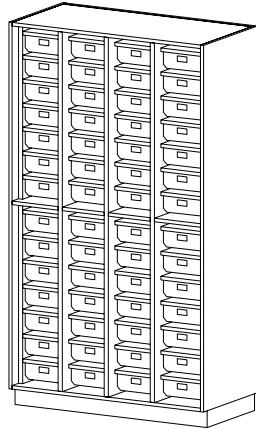

# Tote Tray Storage Tall Cabinets (cont'd)

**CAT. NO T1500**
**DESCRIPTION**

- Open Tote Tray Storage**
- Three fixed vertical partitions
  - Tote tray size: TT120

**HEIGHT** 72 | 78 | 84

**DEPTH** 23

**WIDTH** 48

**T1540**
**Tote Tray Storage with Doors**

- Three fixed vertical partitions
- Tote tray size: TT120
- Two hinged doors

72 | 78 | 84

23

48

**T1470**
**Tote Tray Storage with Doors**

- Two adjustable shelves
- Two fixed vertical partitions
- Tote tray size: 36" w – TT120, 48" w – TT150

72 | 78 | 84

23

36 | 48

**T1570**
**Tote Tray Storage with Doors**

- Two adjustable shelves
- Three fixed vertical partitions
- Tote tray size: TT120
- Four hinged doors

72 | 78 | 84

23

48

# Spray Booth

A Spray Booth offers an economical way to exhaust odors and non-toxic fumes in Laboratory, Class Room and Shop environments.

## Design

The Spray Booth is constructed of 18 gage steel that is formed and welded into a rigid superstructure. Each unit is finished with a chemical resistant powder coat paint finish and has a replaceable, pleated air filter.

The Spray Booth is designed to have a non-explosion proof exhaust blower (specified) mounted directly on top of the unit. A rectangular duct transition is included to connect the exhaust blower to the Spray Booth. For flammable fumes or vapors, an optional explosion-proof exhaust blower must be specified. The explosion-proof exhaust blower is designed to be mounted on the roof or other suitable location, but not on top of the Spray Booth.

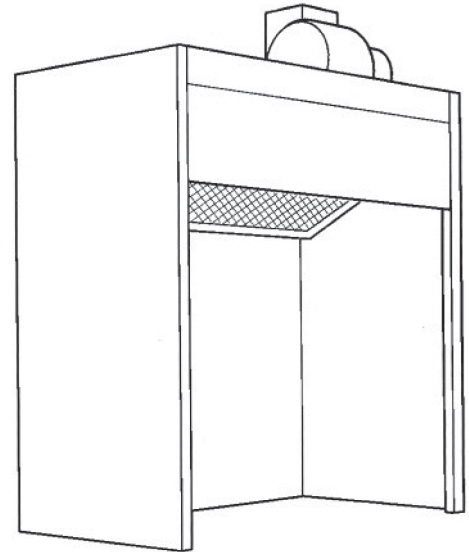

## Interior Lighting

The interior of the Spray Booth is illuminated by a vapor proof incandescent light fixture (bulb included). Light bulb replacement is accomplished from the interior of the booth. When exhausting flammable fumes or vapors, an optional explosion-proof light fixture must be specified.

## Options

Optional service and electrical fixtures are available for use with the Spray Booth. Contact your representative to assist you in specifying these items.

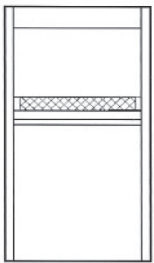

**SB-24**

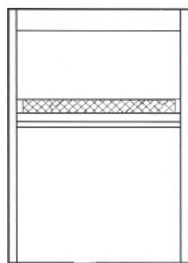

**SB-30**

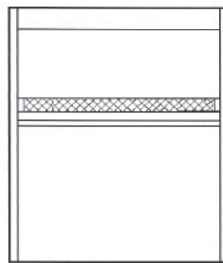

**SB-36**

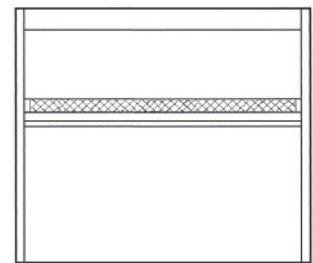

**SB-48**

# Spray Booth (cont'd)

## Exhaust Blowers

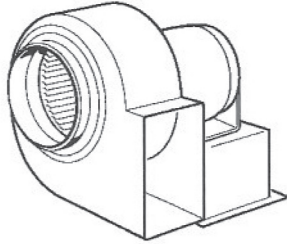

HOOD SIZE	MODEL NUMBER	OUTLET SIZE	HP	CFM AT STATIC PRESSURE SHOWN					
				.125	.25	.375	.5	.625	.75
24"	7C037	4 1/4" X 3/8"	1/4	560	515	470	420	360	300
30"	7C038	5 3/8" X 8 1/4"	1/3	920	870	820	765	710	655
36"	7C039	6 1/2" X 10 3/4"	1/3	968	930	890	850	810	773
48"	7C647	6 1/2" X 10 3/4"	1/3	1160	1125	1090	1035	963	855

Exhaust Blowers feature a dynamically balanced forward curve wheel with cast iron hubs. Housing and motorbase are 16 gage steel with a gray baked-on epoxy finish. Motors are 115V/60HZ with H.P. as shown above. Contact your CiS Solutions representative to assist you in specifying an explosion-proof exhaust blower.

## Replacement Filters

HOOD SIZE	FILTER NUMBER	QUANTITY	SIZE
24"	6556	1	16"x20"
30"	6557	1	22"x20"
36"	6558	2	14"x20"
48"	6559	2	20"x20"

Spray Booth replacement filters are a 1" thick cotton polyester blended filter, laminated to a galvanized steel expanded metal support grid. Order by part number from the chart to the left. (Note: 36" and 48" Spray Booths require two filters.)

## Rough-in Details

HOOD SIZE	DIMENSIONS				
	"A"	"C"	"B"	"D"	"E"
24"	7"	4 3/4"	10 7/16"	10 3/8"	6"
30"	7"	7 3/4"	8"	14"	6"
36"	7"	10 3/4"	10 7/8"	17 5/8"	6 7/8"
48"	7"	19 3/4"	10 7/8"	26 5/8"	6 7/8"

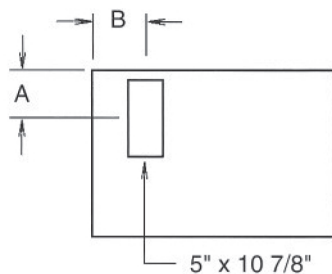

Plan View of  
Spray Booth Top  
Without Blower

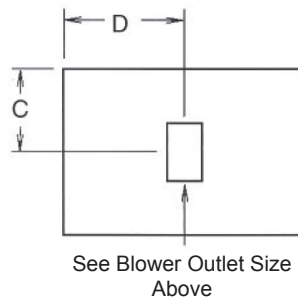

Plan View of  
Spray Booth Top  
With Blower

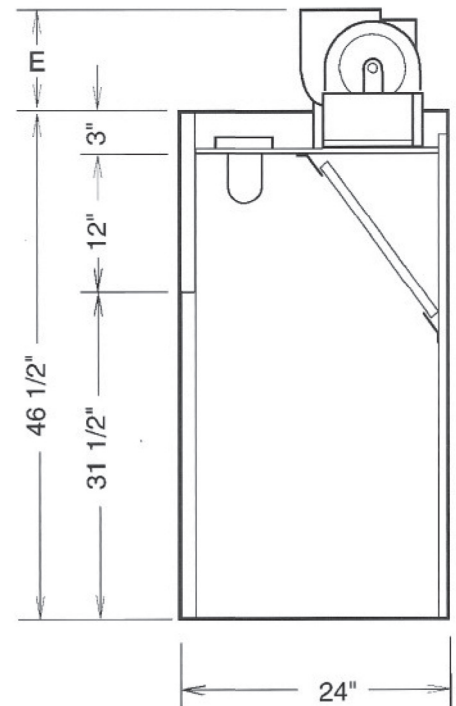

# Arts & Crafts Index

<b>General Information .....</b>	<b>AC-2</b>	<b>Tote Tray Storage Tall Cabinets .....</b>	<b>AC-7</b>
<b>Art &amp; Ceramics.....</b>	<b>AC-3</b>	T1510 Tote Tray Storage with Door .....	AC-7
X5000 Enlarger Station .....	AC-3	T1520 Tote Tray Storage with Door .....	AC-7
H8000 Bench Riser .....	AC-3	T1530 Tote Tray Storage with Door .....	AC-7
X1730 Clay Cart.....	AC-3	T1450 Open Tote Tray Storage.....	AC-7
X1710 Clay Cart Port .....	AC-3	T1460 Tote Tray Storage with Doors.....	AC-7
X1720 Clay Cart Port .....	AC-3	T1550 Open Tote Tray Storage.....	AC-8
X1760 Pull-Out Clay Bin.....	AC-3	T1560 Tote Tray Storage with Doors.....	AC-8
<b>Base Storage.....</b>	<b>AC-4</b>	T1480 Tote Tray Storage with Doors.....	AC-8
B0260 Damp Storage w/Doors.....	AC-4	T1580 Tote Tray Storage with Doors.....	AC-8
B0280 Drying Cabinet .....	AC-4	T1410 Tote Tray Storage with Doors.....	AC-8
B4130 Three Drawer Paper Storage.....	AC-4	T1420 Tote Tray Storage with Doors.....	AC-8
B4140 Four Drawer Paper Storage.....	AC-4	T1430 Tote Tray Storage with Doors.....	AC-8
B4150 Five Drawer Paper Storage .....	AC-4	T1400 Open Tote Tray Storage.....	AC-8
B4160 Six Drawer Paper Storage .....	AC-4	T1440 Tote Tray Storage with Doors.....	AC-8
B4170 Seven Drawer Paper Storage.....	AC-4	T1500 Open Tote Tray Storage.....	AC-9
B4180 Eight Drawer Paper Storage.....	AC-4	T1540 Tote Tray Storage with Doors.....	AC-9
B4230 Four Drawer Storage .....	AC-4	T1470 Tote Tray Storage with Doors.....	AC-9
<b>Tall Storage .....</b>	<b>AC-5</b>	T1570 Tote Tray Storage with Doors.....	AC-9
T4140 Tool Storage.....	AC-5	<b>Spray Booth .....</b>	<b>AC-10</b>
T4160 Tool Storage.....	AC-5	SB-24 Spray Booth .....	AC-10
T0540 Damp Storage.....	AC-5	SB-30 Spray Booth .....	AC-10
T0550 Damp Storage.....	AC-5	SB-36 Spray Booth .....	AC-10
T0560 Drying Cabinet .....	AC-5	SB-48 Spray Booth .....	AC-10
T2510 Smock Storage .....	AC-5	7C037 Exhaust Blower.....	AC-11
T2520 Smock Storage .....	AC-5	7C038 Exhaust Blower.....	AC-11
T2500 Smock Storage .....	AC-6	7C039 Exhaust Blower.....	AC-11
T2610 Apron Storage.....	AC-6	7C647 Exhaust Blower.....	AC-11
T2620 Apron Storage.....	AC-6	6556 Replacement Filter.....	AC-11
T2600 Apron Storage.....	AC-6	6557 Replacement Filter.....	AC-11
		6558 Replacement Filter.....	AC-11
		6559 Replacement Filter.....	AC-11