

# Contents

General Information.....	LS-2
Food Lab .....	LS-3
Sewing Lab.....	LS-4
Base Storage .....	LS-6
Tall Storage.....	LS-7
Accessories .....	LS-9
Finished Backs .....	LS-10
Finished Tops .....	LS-11
Life Skills Index.....	LS-12

# General Information

**Please review the following for Life Skills product information. Contact your CiF Solutions Dealer for any clarifications.**

Casework shown in this section has been pre-engineered specifically for use in the Life Skills department.

Be sure to utilize fillers, especially at walls and corners, for proper leveling and to allow for door and drawer opening clearances.

Cabinets that require locks, finished ends, finished backs, finished tops, specialty hardware or devices, and other options, must be clearly called out or specified accordingly.

# Food Lab

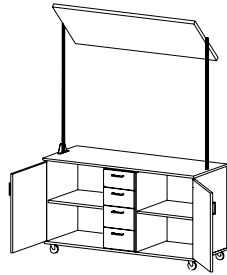
**CAT. NO** **U5320**

**DESCRIPTION** **Mobile Demo w/Mirror**

- Two adjustable shelves
- Four general storage drawers
- Demonstration mirror

**HEIGHT** 30 | 36

**DEPTH** 24 | 29 | 35

**WIDTH** 60

Mirror dimension detail shown on page LS-9.

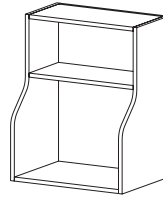
**Y1000**

**Microwave Wall Cabinet**

- One fixed shelf
- Lower microwave shelf has fixed inside depth of 15.91" and a height of 17.73"
- When cabinet height increases, only the inside height of the top compartment increases.
- 0.020" edge on cabinet body

24 | 30 | 36

12 | 14 | 16

24 | 27 | 30 | 33 | 36

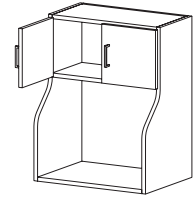
**Y1100**

**Microwave Wall Cabinet**

- One fixed shelf and two hinged doors
- Lower microwave shelf has fixed inside depth of 15.91" and a height of 17.73"
- When cabinet height increases, only the inside height of the top compartment increases.
- 0.020" edge on cabinet body

30 | 36

12 | 14 | 16

24 | 27 | 30 | 33 | 36

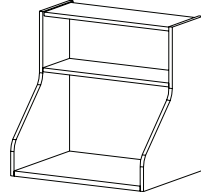
**CAT. NO** **Y1400**

**DESCRIPTION** **Microwave Cabinet**

- Lower microwave shelf has fixed inside depth of 21.65" and a height of 18"
- When cabinet height increases, only the inside height of the top compartment increases.
- 0.020" edge on cabinet body

**HEIGHT** 24 | 30 | 36

**DEPTH** 12 | 14 | 16

**WIDTH** 24 | 27 | 30 | 33 | 36

\* Requires additional in-wall blocking

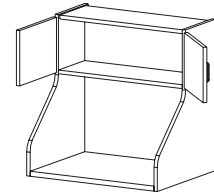
**Y1500**

**Microwave Cabinet**

- Lower microwave shelf has fixed inside depth of 21.65" and a height of 18"
- When cabinet height increases, only the inside height of the top compartment increases.
- 0.020" edge on cabinet body

30 | 36

12 | 14 | 16

24 | 27 | 30 | 33 | 36

\* Requires additional in-wall blocking

# Sewing Lab

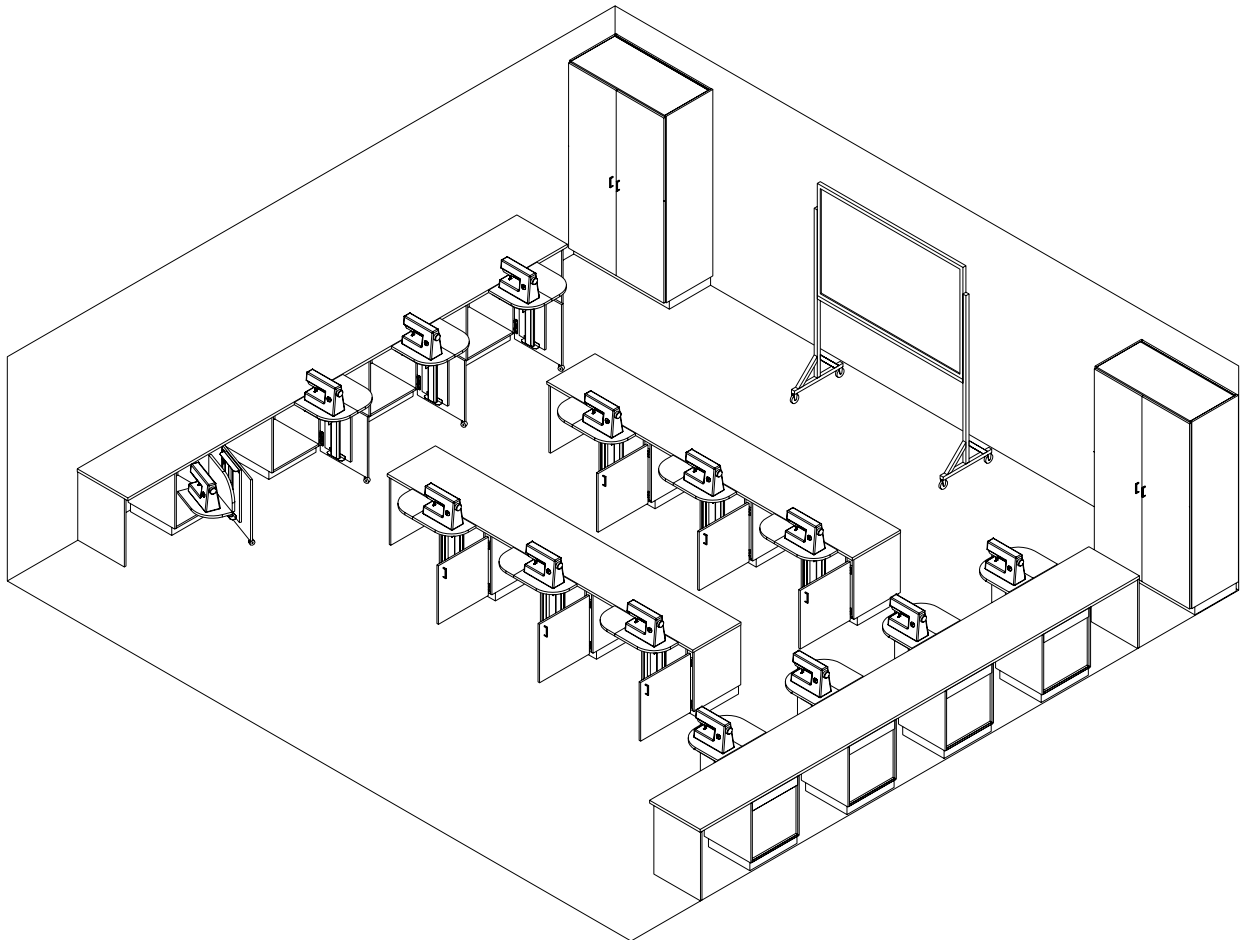

The sewing lab shown here can accommodate up to 14 students utilizing our three sewing machine cabinet variations. In this design all students face forward in order to create the ideal controlled environment conducive to teaching.

All sewing machine cabinets feature:

- Vertical lift mechanism allows machine to remain upright at all times
- 5-knuckle institutional grade hinges
- Leaf style platform provides added work area
- High pressure laminate platform top

\* See page LS-12 for finished back options.

# Sewing Lab (cont'd)

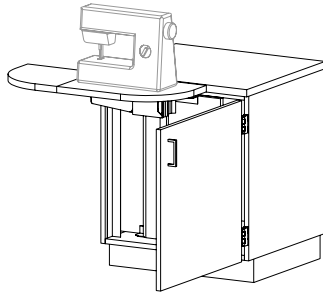

**CAT. NO** X1520

**DESCRIPTION**
**Sewing Machine Cabinet**

- Face forward design
- Sewing machine not included
- Cabinet countertop not included
- Accommodates a maximum sewing machine size of 12" h x 17" lg x 8.25" dp

**HEIGHT** 30

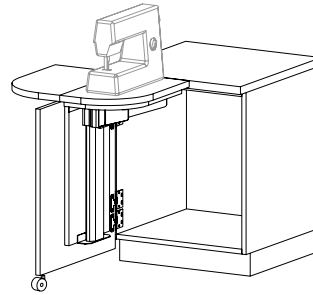
**DEPTH** 24

**WIDTH** 24

**CAT. NO** X1530

**Sewing Machine Cabinet**

- Face left design
- Sewing machine not included
- Cabinet countertop not included
- Accommodates a maximum sewing machine size of 12" h x 17" lg x 8.25" dp

**HEIGHT** 30

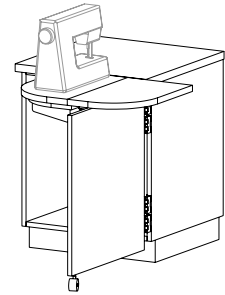
**DEPTH** 24

**WIDTH** 24

**CAT. NO** X1540

**Sewing Machine Cabinet**

- Face right design
- Sewing machine not included
- Cabinet countertop not included
- Accommodates a maximum sewing machine size of 12" h x 17" lg x 8.25" dp

**HEIGHT** 30

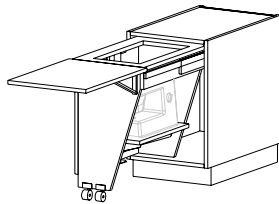
**DEPTH** 24

**WIDTH** 24

**CAT. NO** X1570

**DESCRIPTION**
**Sewing Machine Cabinet**

- Face left design
- Sewing machine not included
- Cabinet countertop not included
- Accommodates a maximum sewing machine size of 15" h x 18.5" lg x 9.5" dp

**HEIGHT** 30

**DEPTH** 29

**WIDTH** 18 (66" fully open)

# Base Storage

Refer to the General Base Casework section for a complete line of storage solutions.

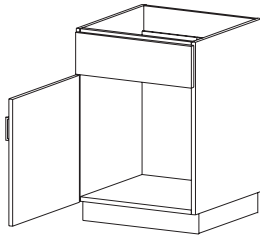

**CAT. NO** **B2110** (Hinged L) **B2120** (Hinged R)

**DESCRIPTION** Single Door Sink Cabinet

**HEIGHT** \*26 | 30 | 32 | 34 | 36 | 39 | 42 | 48

**DEPTH** 12 | 14 | 16 | 18 | 21 | 24 | 29 | 35

**WIDTH** 12 | 15 | 18 | 21 | 24

\*26" height not available in a width greater than 21"

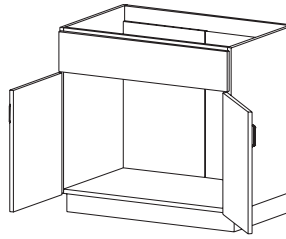

**B2100**

**Sink Cabinet**

\*26 | 30 | 32 | 34 | 36 | 39 | 42 | 48

12 | 14 | 16 | 18 | 21 | 24 | 29 | 35

24 | 27 | 30 | 33 | 36 | 39 | 42 | 45 | 48

\*26" height not available in a width greater than 45"

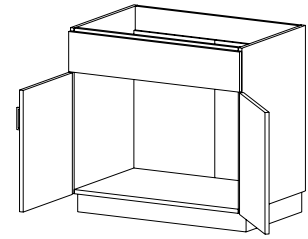

**B2500**

**Cooktop Cabinet**

- Range panel behind false front

30 | 32 | 34 | 36 | 39 | 42 | 48

24 | 29 | 35

24 | 27 | 30 | 33 | 36 | 39 | 42 | 45 | 48

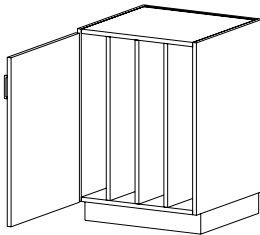

**CAT. NO** **B0410** (Hinged L) **B0420** (Hinged R)

**DESCRIPTION** Vertical Divided Storage

- Three fixed vertical partitions
- One hinged door

**HEIGHT** 24 | 26 | 30 | 32 | 34 | 36 | 39 | 42 | 48

**DEPTH** 12 | 14 | 16 | 18 | 21 | 24 | 29 | 35

**WIDTH** 15 | 18 | 21 | 24

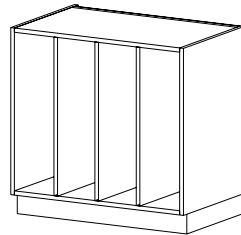

**B0400**

**Vertical Divided Storage**

- Three fixed vertical partitions

24 | 26 | 30 | 32 | 34 | 36 | 39 | 42 | 48

12 | 14 | 16 | 18 | 21 | 24 | 29 | 35

15 | 18 | 21 | 24 | 27 | 30 | 33 | 36 | 39  
42 | 45 | 48

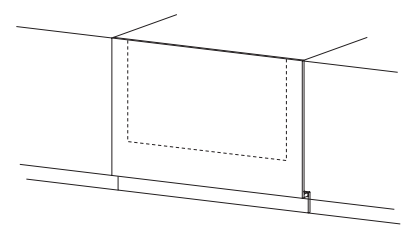

**R2900**

**Set-In Range Filler**

- Includes toe kick
- Cut out by installer

24 | 26 | 30 | 32 | 34 | 36 | 39 | 42 | 48

03

24 | 27 | 30 | 33 | 36 | 39 | 42 | 45 | 48

# Tall Storage

Refer to the General Tall Casework section for a complete line of storage solutions.

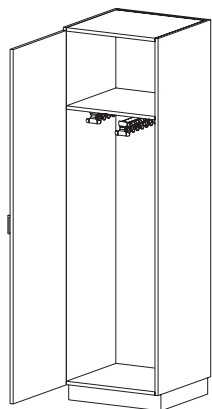

**CAT. NO** **T2510**  
(Hinged L)      **T2520**  
(Hinged R)

**DESCRIPTION** **Smock Storage**

- One fixed shelf
- One hinged door
- Two pull-out racks mounted under shelf – each rack features 14 hooks

**HEIGHT** 84

**DEPTH** 24

**WIDTH** 24

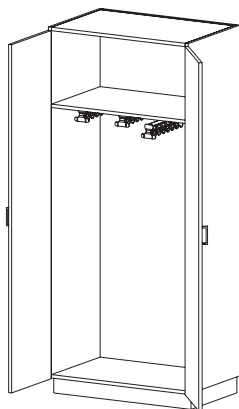

**T2500**

**DESCRIPTION** **Smock Storage**

- One fixed shelf
- Two hinged doors
- Three pull-out racks mounted under shelf (48" w has four racks) – each rack features 14 hooks

**HEIGHT** 84

**DEPTH** 24

**WIDTH** 36 | 39 | 42 | 45 | 48

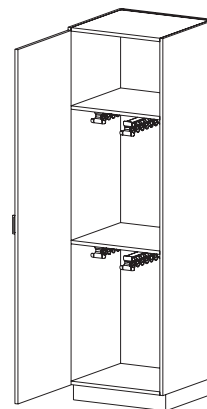

**CAT. NO** **T2610**  
(Hinged L)      **T2620**  
(Hinged R)

**DESCRIPTION** **Apron Storage**

- Two fixed shelves
- One hinged door
- Two pull-out racks mounted under each shelf – each rack features 14 hooks

**HEIGHT** 84

**DEPTH** 24

**WIDTH** 24

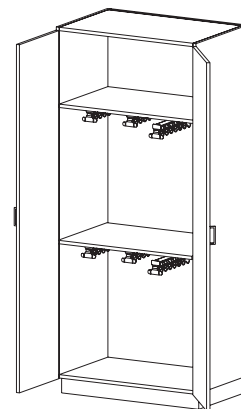

**T2600**

**DESCRIPTION** **Apron Storage**

- Two fixed shelves
- Two hinged doors
- Three pull-out racks mounted under each shelf (48" w has four racks per shelf) – each rack features 14 hooks

**HEIGHT** 84

**DEPTH** 24

**WIDTH** 36 | 39 | 42 | 45 | 48

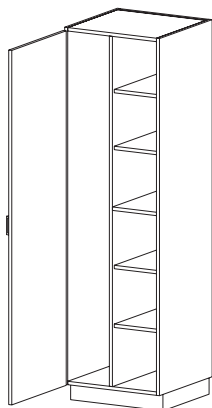

**CAT. NO** **T4010**  
(Hinged L)      **T4020**  
(Hinged R)

**DESCRIPTION** **Ironing Board Storage**

- Heat-resistant shelves store six irons
- Space for ironing boards
- One hinged door

**HEIGHT** 72 | 78 | 84 | 86 | 88 | 90 | 95

**DEPTH** 24 | 29

**WIDTH** 21 | 24

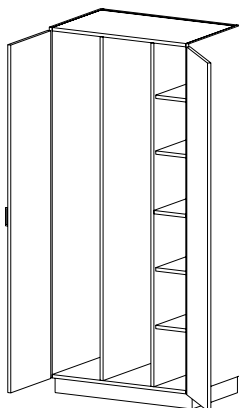

**T4030**

**DESCRIPTION** **Ironing Board Storage**

- Heat-resistant shelves store six irons
- Space for ironing boards
- Two hinged doors

**HEIGHT** 72 | 78 | 84 | 86 | 88 | 90 | 95

**DEPTH** 24 | 29

**WIDTH** 27 | 30 | 33 | 36

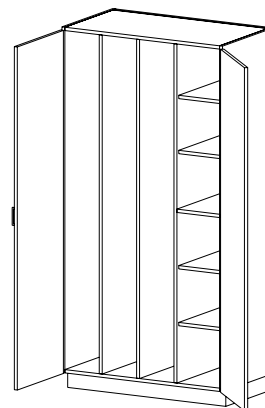

**T4040**

**DESCRIPTION** **Ironing Board Storage**

- Heat-resistant shelves store six irons
- Space for ironing boards
- Two hinged doors

**HEIGHT** 72 | 78 | 84 | 86 | 88 | 90 | 95

**DEPTH** 24 | 29

**WIDTH** 39 | 42 | 45 | 48

# Tall Storage (cont'd)

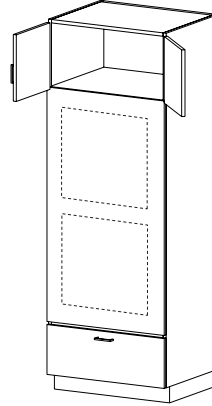
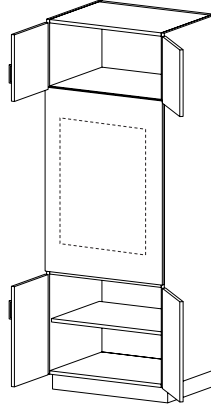
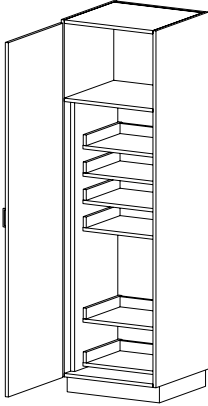
**CAT. NO**
**T4510**  
(Hinged L)

**T4520**  
(Hinged R)

**DESCRIPTION**
**Pantry Storage**

- Six roll-out shelves
- One hinged door

**T4440**
**Single Oven Cabinet**

- Two hinged doors above and below oven compartment
- One adjustable shelf below

**T4460**
**Double Oven Cabinet**

- Two hinged doors above oven compartment and one drawer below

**HEIGHT** 84

84

84

**DEPTH** 24 | 29

24 | 29

24 | 29

**WIDTH** 18 | 21 | 24

30 | 33 | 36

30 | 33 | 36

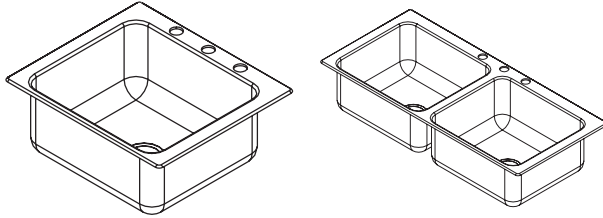

# Accessories

**CAT. NO** **KS010**

**DESCRIPTION** **7-1/2" Deep Single Bowl Stainless Steel Sink**

- 17" x 21" with 14" x 16" bowl size
- 3-1/2" waste outlet with crumb cup and tail piece

**CAT. NO** **KS020**

**DESCRIPTION** **8" Deep Double Bowl Stainless Steel Sink**

- 33" x 21" with 14" x 16" bowl size
- 3-1/2" waste outlet with crumb cup and tail piece

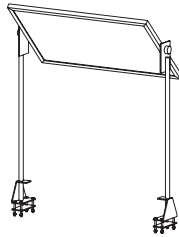
**CAT. NO** **DM010**

**DESCRIPTION** **Demonstration Mirror**

- Bolts to countertop

<b>H</b>	52 (variable)
<b>D</b>	17 (variable)
<b>W</b>	32   44   52   56   58   64   68

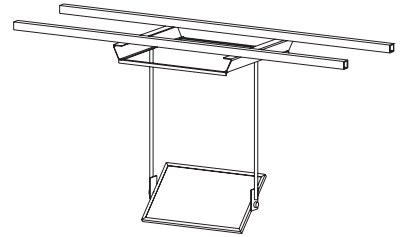
**CAT. NO** **DC010**

**DESCRIPTION** **Ceiling and Track Mounted Demonstration Mirror**

- 22"xW mirror
- Ceiling track is 10' in length

<b>H</b>	52 (variable)
<b>D</b>	17 (variable)
<b>W</b>	32   44   52   56   58   64

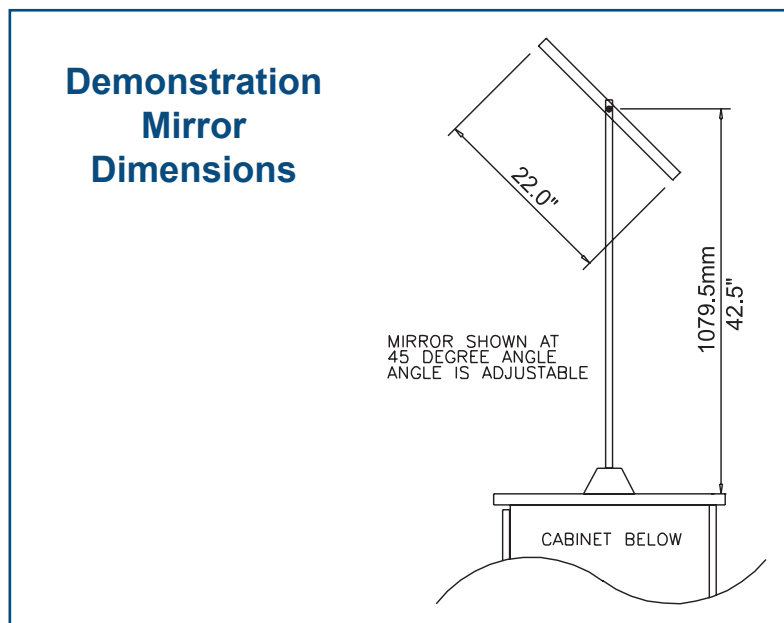

# Finished Backs

## Horizontal Grained Finished Backs

**F4000** (96mm from bottom) **F4001** (to floor)

Individual Unit (No Tite-Joint)

**H** 12 to 48

**D** 01

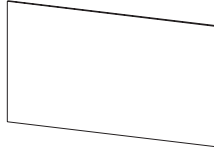
**W** 12 to 95

**F4010** (96mm from bottom) **F4011** (to floor)

Starter Unit (Mechanical Fastener Right Edge)

**H** 12 to 48

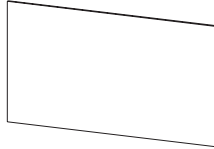
**D** 01

**W** 12 to 95

**F4020** (96mm from bottom) **F4021** (to floor)

Adder Unit (Mechanical Fastener Left &amp; Right)

**H** 12 to 48

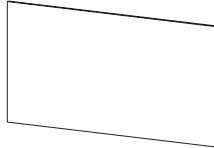
**D** 01

**W** 12 to 95

**F4030** (96mm from bottom) **F4031** (to floor)

Right End Unit (Mechanical Fastener Left Edge)

**H** 12 to 48

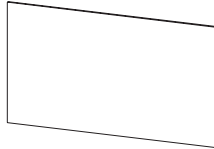
**D** 01

**W** 12 to 95

**F4050** (96mm from bottom) **F4051** (to floor)

Starter Unit (Biscuit Joined)

**H** 12 to 48

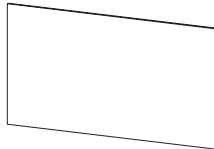
**D** 01

**W** 12 to 95

**F4060** (96mm from bottom) **F4061** (to floor)

Adder Unit (Biscuit Joined)

**H** 12 to 48

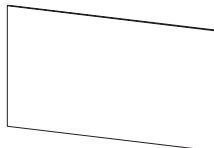
**D** 01

**W** 12 to 95

**F4070** (96mm from bottom) **F4071** (to floor)

Right End Unit (Biscuit Joined)

**H** 12 to 48

**D** 01

**W** 12 to 95



## Vertical Grained Finished Backs

**F4100** (96mm from bottom) **F4101** (to floor)

Individual Unit (No Tite-Joint)

**H** 12 to 95

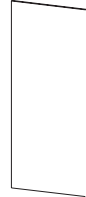
**D** 01

**W** 12 to 48

**F4110** (96mm from bottom) **F4111** (to floor)

Starter Unit (Mechanical Fastener Right Edge)

**H** 12 to 95

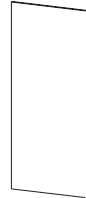
**D** 01

**W** 12 to 48

**F4120** (96mm from bottom) **F4121** (to floor)

Adder Unit (Mechanical Fastener Left &amp; Right)

**H** 12 to 95

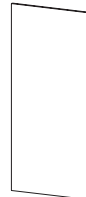
**D** 01

**W** 12 to 48

**F4130** (96mm from bottom) **F4131** (to floor)

Right End Unit (Mechanical Fastener Left Edge)

**H** 12 to 95

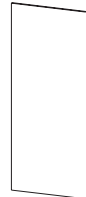
**D** 01

**W** 12 to 48

**F4150** (96mm from bottom) **F4151** (to floor)

Starter Unit (Biscuit Joined)

**H** 12 to 95

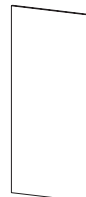
**D** 01

**W** 12 to 48

**F4160** (96mm from bottom) **F4161** (to floor)

Adder Unit (Biscuit Joined)

**H** 12 to 95

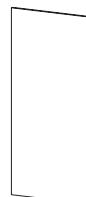
**D** 01

**W** 12 to 48

**F4170** (96mm from bottom) **F4171** (to floor)

Right End Unit (Biscuit Joined)

**H** 12 to 95

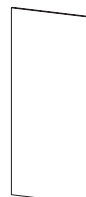
**D** 01

**W** 12 to 48

# Finished Tops

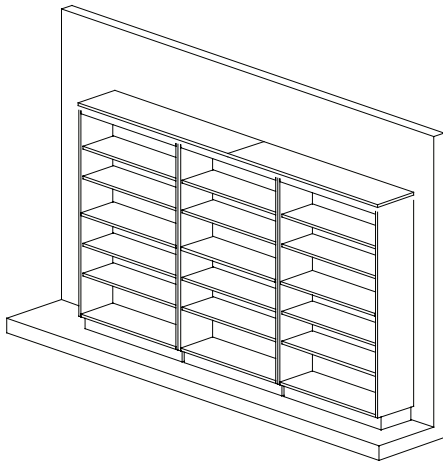

**F5000** For runs of casework. Left or right ends finished as needed.

**Continuous Top**

**D** 12 | 13 | 15 | 17 | 22

**W** Any length as needed - 12" min. to max. panel length of 95"

NOTE: If over 96" wide, parts are joined with mechanical fasteners

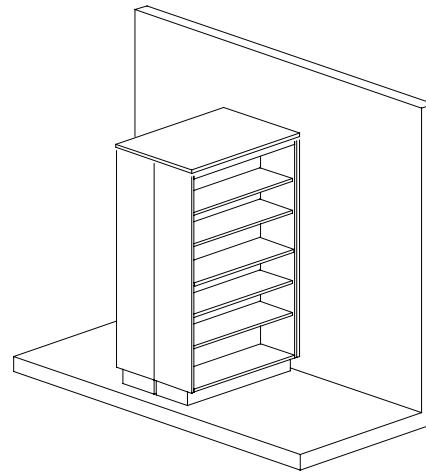

**F5050** For peninsula casework. Left or right ends finished as needed.

**Continuous Double-sided Top**

**D** Any depth as needed

**W** Any length as needed - 12" min. to max. panel length of 95"

NOTE: If over 96" wide, parts are joined with mechanical fasteners

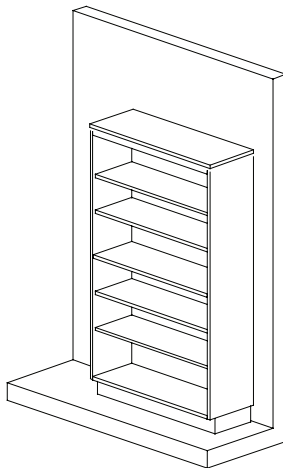

**F5200** For individual casework. Left or right ends finished as needed.

**Individual Top**

**D** 12 | 13 | 15 | 17 | 22

**W** All standard nominal widths available  
12" to 96"

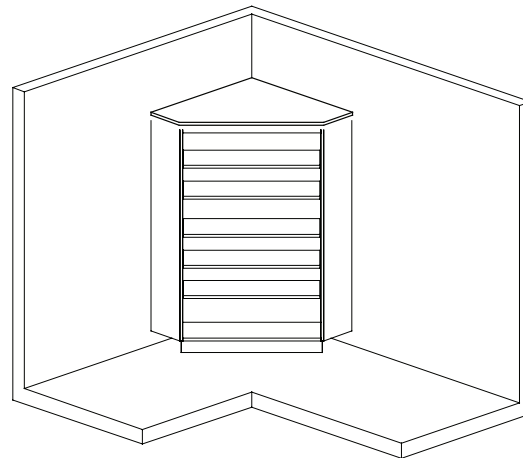

**F5300** For corner mounted casework. Left or right ends finished as needed.

**Corner Unit Top**

**D** Custom - 12" min. to 48" max.

**W** Custom - 12" min. to 48" max.

# Life Skills Index

**General Information ..... LS-2**
**Food Lab ..... LS-3**

U5320	Mobile Demo w/Mirror.....	LS-3
Y1000	Microwave Wall Cabinet.....	LS-3
Y1100	Microwave Wall Cabinet.....	LS-3
Y1400	Microwave Cabinet.....	LS-3
Y1500	Microwave Cabinet.....	LS-3

**Sewing Lab..... LS-4**

X1520	Sewing Machine Cabinet.....	LS-5
X1530	Sewing Machine Cabinet.....	LS-5
X1540	Sewing Machine Cabinet.....	LS-5
X1570	Sewing Machine Cabinet.....	LS-5

**Base Storage ..... LS-6**

B2110	Single Door Sink Cabinet.....	LS-6
B2120	Single Door Sink Cabinet.....	LS-6
B2100	Sink Cabinet.....	LS-6
B2500	Cooktop Cabinet.....	LS-6
B0410	Vertical Divided Storage.....	LS-6
B0420	Vertical Divided Storage.....	LS-6
B0400	Vertical Divided Storage.....	LS-6
R2900	Set-In Range Filler.....	LS-6

**Tall Storage ..... LS-7**

T2510	Smock Storage.....	LS-7
T2520	Smock Storage.....	LS-7
T2500	Smock Storage.....	LS-7
T2610	Apron Storage.....	LS-7
T2620	Apron Storage.....	LS-7
T2600	Apron Storage.....	LS-7
T4010	Ironing Board Storage.....	LS-7
T4020	Ironing Board Storage.....	LS-7
T4030	Ironing Board Storage.....	LS-7
T4040	Ironing Board Storage.....	LS-7
T4510	Pantry Storage.....	LS-8
T4520	Pantry Storage.....	LS-8
T4440	Single Oven Cabinet.....	LS-8
T4460	Double Oven Cabinet.....	LS-8

**Accessories ..... LS-9**

KS010	7-1/2" Deep Single Bowl Stainless Steel Sink.....	LS-9
KS020	8" Deep Double Bowl Stainless Steel Sink.....	LS-9
DM010	Demonstration Mirror.....	LS-9
DC010	Ceiling and Track Mounted Demonstration Mirror.....	LS-9

**Finished Backs ..... LS-10**

F4000	Individual Unit (No Tite-Joint).....	LS-10
F4001	Individual Unit (No Tite-Joint).....	LS-10
F4010	Starter Unit (Mechanical Fastener Right Edge).....	LS-10
F4011	Individual Unit (No Tite-Joint).....	LS-10
F4020	Adder Unit (Mechanical Fastener Left & Right).....	LS-10
F4021	Individual Unit (No Tite-Joint).....	LS-10
F4030	Right End Unit (Mechanical Fastener Left Edge).....	LS-10
F4031	Individual Unit (No Tite-Joint).....	LS-10
F4050	Starter Unit (Biscuit Joined).....	LS-10
F4051	Individual Unit (No Tite-Joint).....	LS-10
F4060	Adder Unit (Biscuit Joined).....	LS-10
F4061	Individual Unit (No Tite-Joint).....	LS-10
F4070	Right End Unit (Biscuit Joined).....	LS-10
F4071	Individual Unit (No Tite-Joint).....	LS-10
F4100	Individual Unit (No Tite-Joint).....	LS-10
F4101	Individual Unit (No Tite-Joint).....	LS-10
F4110	Starter Unit (Mechanical Fastener Right Edge).....	LS-10
F4111	Starter Unit (Tite-Joint Right Edge).....	LS-10
F4120	Adder Unit (Mechanical Fastener Left & Right).....	LS-10
F4121	Adder Unit (Tite-Joint Left & Right).....	LS-10
F4130	Right End Unit (Mechanical Fastener Left Edge).....	LS-10
F4131	Right End Unit (Tite-Joint Left Edge).....	LS-10
F4150	Starter Unit (Biscuit Joined).....	LS-10
F4151	Starter Unit (Bisquet Joined).....	LS-10
F4160	Adder Unit (Biscuit Joined).....	LS-10
F4161	Adder Unit (Bisquet Joined).....	LS-10
F4170	Right End Unit (Biscuit Joined).....	LS-10
F4171	Right End Unit (Bisquet Joined).....	LS-10

**Finished Tops ..... LS-11**

F5000	Continuous Top.....	LS-11
F5050	Continuous Double-sided Top.....	LS-11
F5200	Individual Top.....	LS-11
F5300	Corner Unit Top.....	LS-11